

Stops rising damp in masonry

Resin based
Salt content irrelevant
Stays elastic

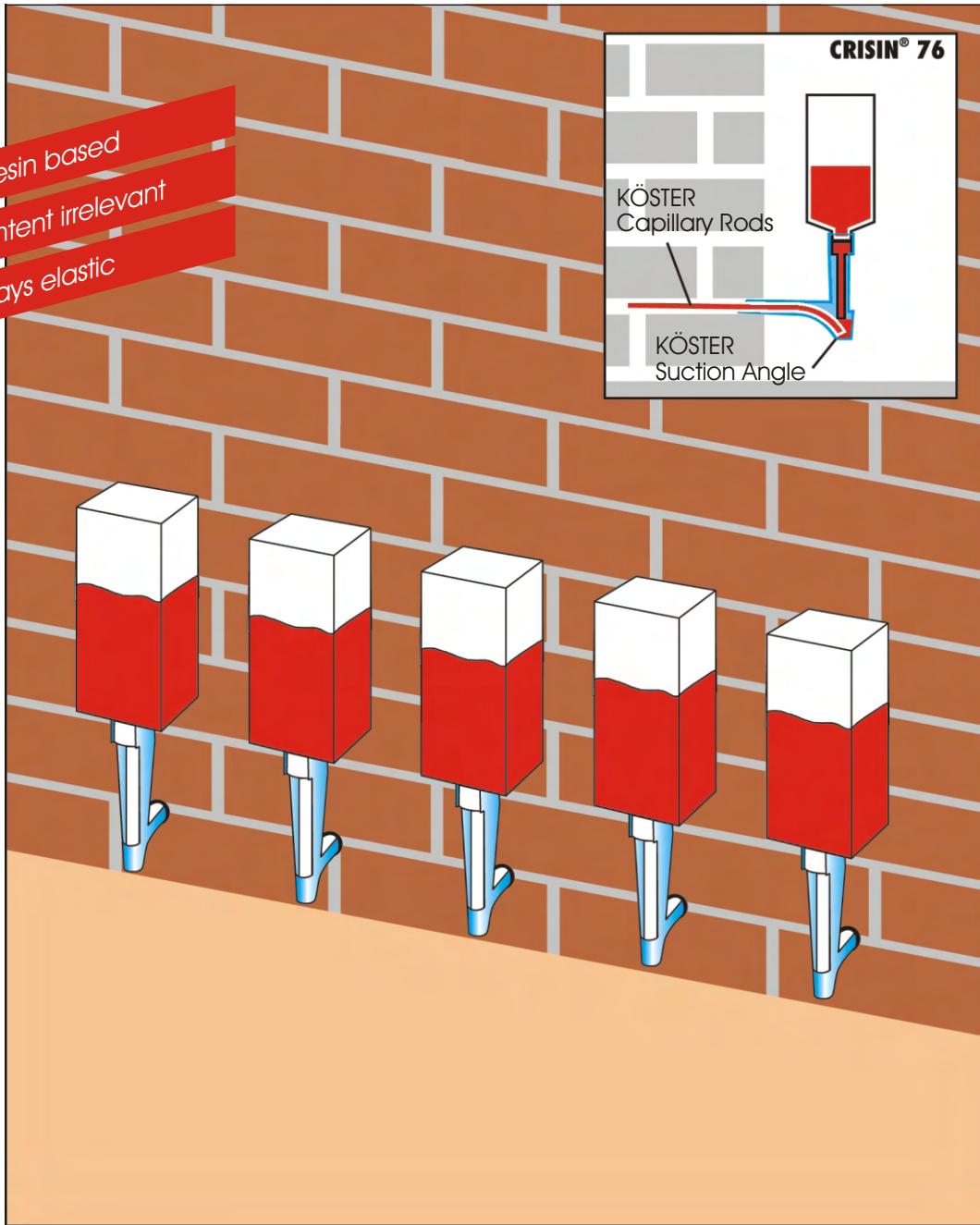

CRISIN[®] 76

For creating horizontal rising damp barriers through capillary absorption

KÖSTER
Waterproofing Systems

CRISIN® 76

Cartridge method against rising dampness

The CRISIN® 76 cartridge method is the Optimal rising damp barrier for all kinds of masonry and brickwork. With the Capillary rod (patented) and the newly developed KÖSTER Suction Angle ensures an even easier and more powerful placement of a new rising damp barrier created with CRISIN® 76.

Via the KÖSTER Capillary Rod and the KÖSTER Suction Angle the CRISIN® 76 liquid is transported into the masonry capillaries. The Suction Angle ensures that the material is distributed through capillary absorption rather than pressure and thus better penetration and the Capillary Rod which is made from a highly absorptive cellular material ensures that cracks and cavities are suitable bridged and no material is wasted. CRISIN® 76 is thus Optimal and evenly distributed and a well function rising damp barrier functioning for decades can be ensured.

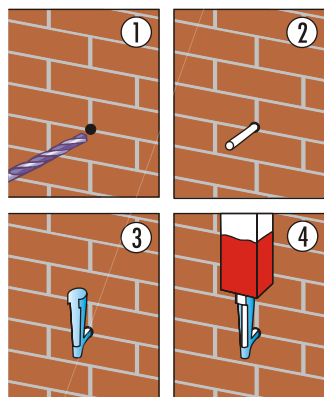
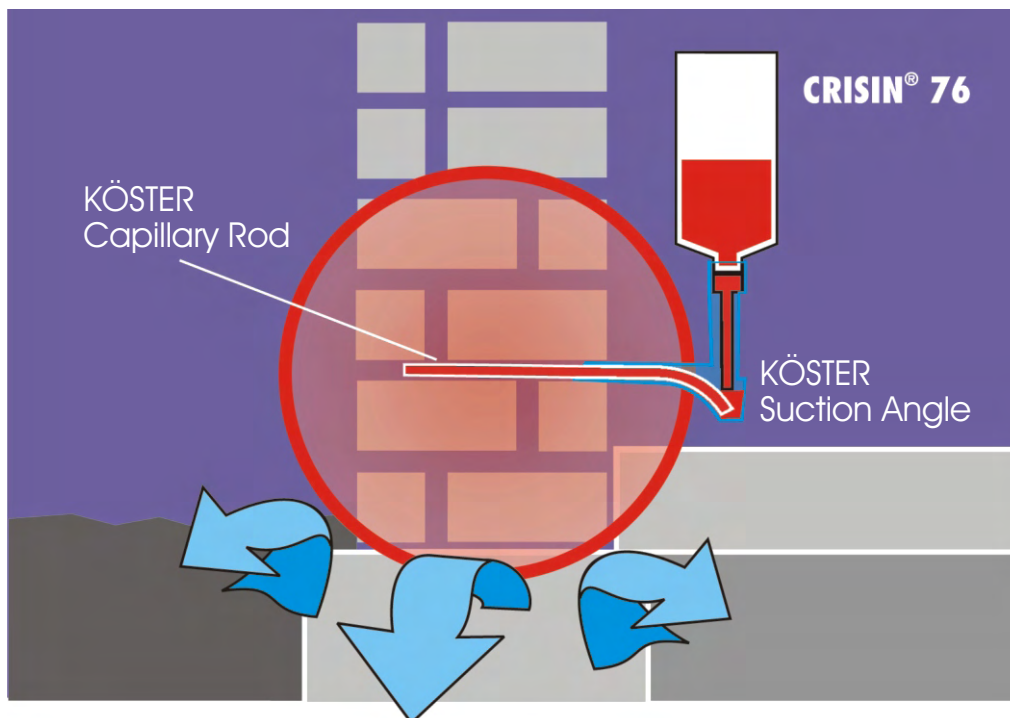

This is how it's done:

① The drilling holes are drilled vertically in the lowest pointing joint. Diagonal drilling is avoided and thus the masonry is not unnecessarily weakened.

② The Capillary Rods are inserted into the bore holes.

③ The Suction Angle creates the bridge between the Capillary Rod and the Cartridge.

④ CRISIN® 76 is then distributed evenly with the exact amount required.

Article No.	KÖSTER Product	Properties	Usage
3.082	CRISIN® 76-Cartridge	Pores and capillaries are permanent sealed	Place cartridge in the Suction Angle
11.06	KÖSTER Capillary Rod	The expansive cellular structure of the rod ensures an even distribution of CRISIN® 76	Place cartridge in the Suction Angle
12.03087	KÖSTER Suction Angle	Dosage angle for CRISIN® 76	Place in the bore holes.
For an optima result we recommend the following auxiliary products:			
3.05	MAUTROL® Borehole suspension	Seals the bore holes	Place in the bore holes.
4.13	KÖSTER Anti Sulphate	Improves the substrate strength and protects against aggressive salts.	Brush or spray on the wall.
5.06	KÖSTER Restoration Plasters	Diffusion open, hydrophobic, thermal insulating and the ability to store salts	Plaster on the wall
7.13	POLYSIL® TG 500	A special in-depth primer to Improve the substrate strength and for use on damp and salty substrates.	Brush or spray on the wall.

The result can be seen:

An elastic and non-rotting rising damp barrier – and thereby permanent dry walls. With the KÖSTER waterproofing systems you not save money and material but also your nerves. And because the ideas is so good - we have even patented it all.

German Patent No.: 4306687;
European Patent: 0687333

Distributed through:

